

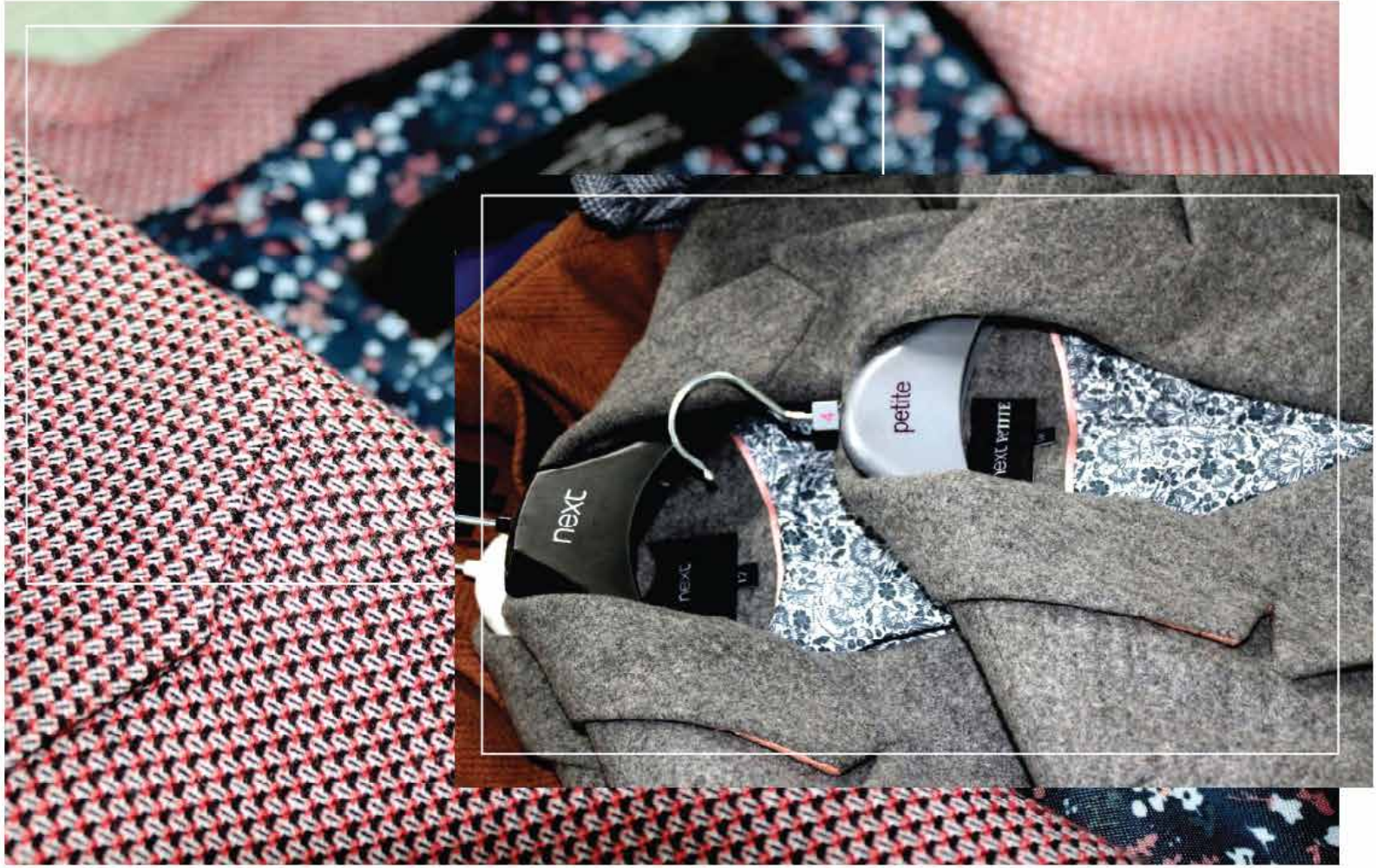

VIRGO M H LIMITED

(Virgo Mahabuba Holdings Limited)



Address & Contact

Bangladesh Head Office

House #178, Road # 2, Baridhara D.O.H.S, Dhaka - 1206, Bangladesh
Phone : +880 2 8410674

Factory

43/2, Gazipura, BOF, Gazipur Sadar, Gazipur, Bangladesh

Contact Person

Syed Nafiz Nazrul Raiyan
Chairman
Head Office

Phone: +8801847 137 186
email: raiyan@virgo.com.bd

Syed Ishmum Farooque
Managing Director
Head Office

Phone: +88 01730 352 222
email: ishmum@virgo.com.bd

Amal Halder
Deputy Managing Director
Head Office

Phone: +8801847 137 195
email: amal@virgo.com.bd

www.VirgoMH.com

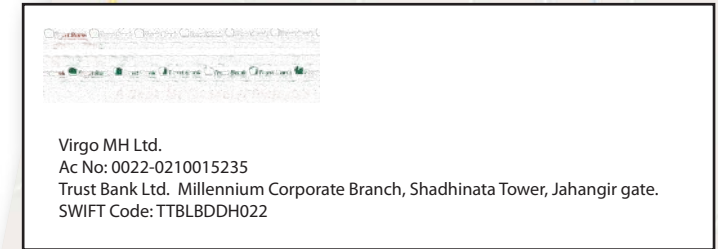



2

Virgo M H Limited

ACCORD Green Standard
on Fire and Building Safety in Bangladesh

3
The Factory



4

Practices
& Facilities



5

Our
Factory Space
Workforce

6



Factory Layout



11

Our Products
Our Buyers



15

Store Department

16

Fire Safety



Measures



17

General Safety
Measures



18

Security Measures



20

Worker welfare



23

Special Machines

19

Utilities



22

Facilities



27

CAD Section



28

Machine List



Green Standard

Maintaining the compliance as per requirement of European buyers (Accord),
Factory is "Green" standard

The Bangladeshi clothing manufacturer's share of the global market is steadily growing in the wake of the success of the Ready-made Garments (RMG) sector. Virgo M H is also willing to compete in the global market to provide superior quality products to the buyers and achieve its desired goal.

Virgo M H Limited is a modern factory equipped with the latest Automation Machinery from Juki and other world-class brands which made in Japan, China, Korea, Taiwan, Malaysia, Germany, UK, etc.

Virgo M H Limited with skilled workers, breathing environment and relaxed working atmosphere, wants to prove itself as a well designed and well equipped modern factory of Bangladesh.



NEXT & "C&A" APPROVED FACILITY



VIRGO M H LIMITED

The Factory

This Factory has extended all the Facilities to its human resource as,

- # Standard wage rate,
- # Attendance bonuses,
- # Excellent Dining area,
- # Productivity bonuses,
- # Overtime rate as per local law,
- # Standard clean & hygienic Toilets,
- # Day care center for workers children,
- # Full time Doctor & Nurse Facility,
- # Occupational & fire safe environmental friendly working area.

A person wearing a blue shirt and a green safety vest is working on a machine. The background is a light blue wall.

P r a c t i c e s

- The company strictly prohibits practice of discrimination and employment of any child or forced labour --
- The company abides by all code of conduct practices of most of the apparel imports of USA & EU --
- The Company highly regarded for its quality control management practice --

F a c i l i t i e s

- Open space for every worker as per the internationally accepted compliance law --
- Modern firefighting equipment and easy evacuation plan for emergency exit as per labour law policy --
- Group insurance for all staff and workers as per labour law policy act 2006 --
- Medical room with specialized doctor & nurses with emergency supporting equipment with medicines as per labour law policy --
- Clean and hygienic environment everywhere --
- Day-care center for babies of female workers as per labour law policy --
- Dinning hall facility for all factory workers & staff as per labour law policy --
- Cooling fans fixed to the wall for breathing environment and to make the floor cool --
- 24 Hours standby generator facility. 2 Nos Generator 650 KW each --
- All over the factory well designed layout and fire evacuation plan for easy exit during emergency time --
- Separate Prayer rooms for male & female workers --
- Virgo M H Ltd is fully equipped with public announcing system (PA System) --
- Enough number of exit gates for emergency exit --
- Adequate Fire hydrant and sprinkler system in case of fire --

quality

Quality management system (QMS) is Placed in Our Facility that documents processes, procedures, and responsibilities for achieving quality policies and objectives.

It helps coordinate and directs Our organization activities to meet customer and regulatory requirements and improve its effectiveness and efficiency continuously.

Quality management systems serve many purposes in Our Organization as below

- Improving processes and help to do Right First time.
- Reducing waste.
- Lowering costs.
- Facilitating and identifying training opportunities
- Engaging staff
- Setting an organization-wide direction.

Virgo M H Moto is Always QUALITY FIRST.



TOTAL AREA 1,63,945 SQ FT
PER PRODUCTION FLOOR 48,650 SQ FT

work force

Right now there are 600
Workers and staff work together

By December 2019,
There will be 1100 workers and staff

factory space

Virgo M H Ltd Comprising of
2 Storied garments building,
Covering Warehouse, Cutting, Sewing,
Finishing, Dinning / Canteen, Doctor's room
and Day Care facilities

strengths

Virgo M H Strength is Having Well Trained Skill
workforce Including Multi skill Staff Who Can Handle
Any Kind of product Maintaining Highest Quality
Standard

FACTORY GROUND & GROUND FLOOR
ফ্যাক্টরী গ্রাউন্ড এন্ড গ্রাউন্ড ফ্লোর



LEGEND

| | |
|--|--|
| PILLAR HYDRANT পিলার হাইড্রেন্ট | I am here আমার অবস্থান |
| Fire Door ফায়ার ডোর | Pure Water বিশুদ্ধ পানি |
| Hose Pipe হোজ পাইপ | Pillar পিলার |
| P.A System পিএ সিস্টেম | Smoke Detector স্মোক ডিটেক্টর |
| Fire Equipment ফায়ার ইকুইপমেন্ট | Fire Extinguisher অগ্নি নির্বাপক বস্ত্র |
| CCTV সিসিটিভি | Exit বাহির |
| First Aid Box ফার্স্ট অয়েড বক্স | Fog Light ফগ লাইট |
| Fire Alarm Switch ফায়ার অ্যালার্ম সুইচ | Danger বিপদজনক |

TOTAL LAND AREA 80,970 SQ FT



Virgo M H Limited

EMERGENCY FIRE SAFETY & EVACUATION PLAN

জরুরী অগ্নি নিরাপত্তা ও বহির্গমন পরিকল্পনা

1ST FLOOR ২য় তলা



1ST FLOOR WITH TOILET BLOCK AREA 48,665 SQ FT

LEGEND

- PILLAR HYDRANT
পিলার হাইড্রেন্ট
- FIRE DOOR
আগের দরজা
- HOSE PIPE
হোস পাইপ
- PA SYSTEM
পাবা সিস্টেম
- FIRE EQUIPMENT
আগের যন্ত্রপাতি

CCTV
কিউটিভি

- FIRST AID BOX
ফার্স্ট অয়েড বক্স
- FIRE ALARM SWITCH
আগের অ্যালার্ম স্যুইচ
- I AM HERE
আমার অবস্থান
- PURE WATER
শুদ্ধ পানি
- SMOKE DETECTOR
স্মোক ডিটেক্টর

FIRE EXTINGUISHER
আগের নিবৃত্তক যন্ত্র

- EXIT
বাহির
- FOG LIGHT
ফগ লাইট
- DANGER
বিপদ
- PILLAR
পিলার

EMERGENCY FIRE SAFETY & EVACUATION PLAN জরুরী অগ্নি নিরাপত্তা ও বহিগমন পরিকল্পনা

UTILITY BUILDING(GROUND FLOOR) ইউটিলিটি বিল্ডিং(নীচ তলা)

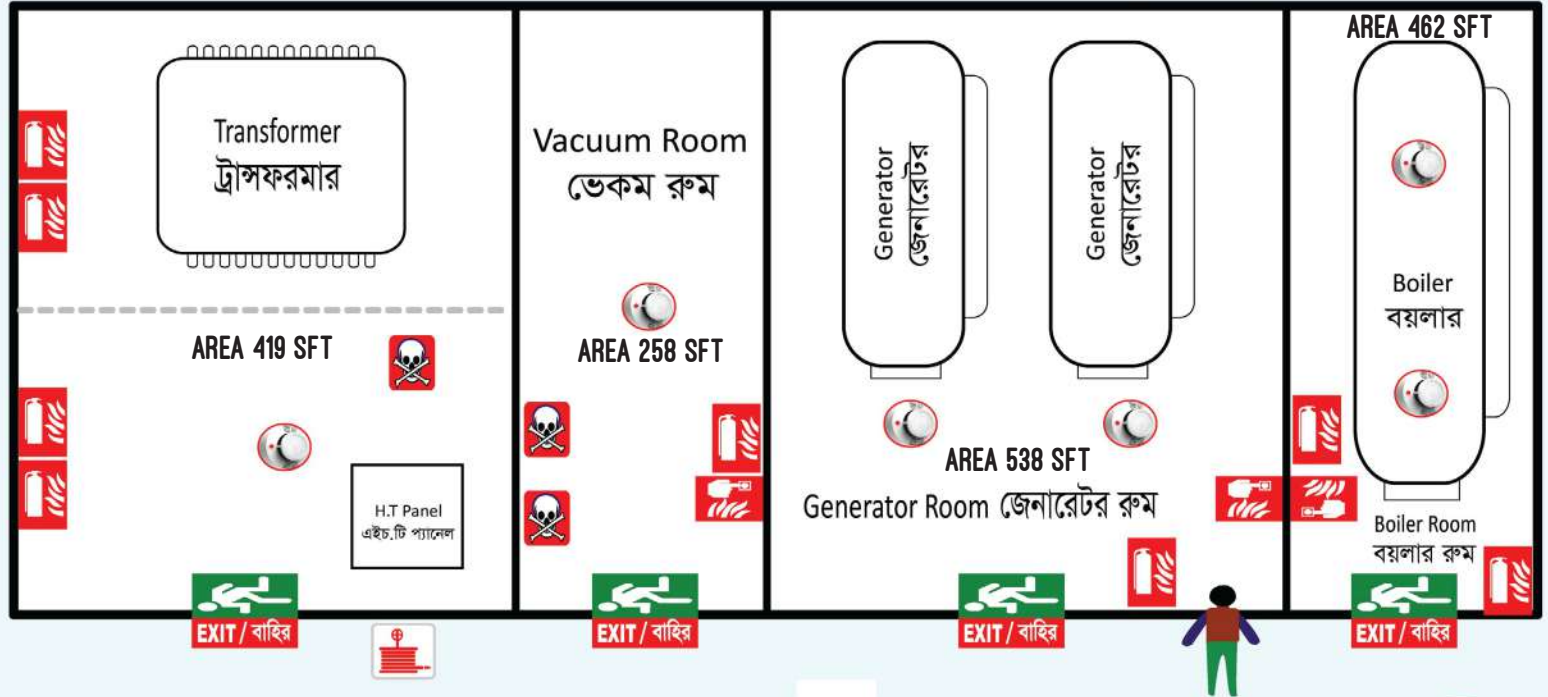

| LEGEND | | I am here আমার অবস্থান | Hose Pipe হোজ পাইপ | Pillar পিলার | Fire Equipment অগ্নি নির্বাপনী সরঞ্জাম | Fire Extinguisher অগ্নি নির্বাপক যন্ত্র | First Aid Box প্রাথমিক চিকিৎসা বাক্স | Fog Light ফগ বাতি |
|-------------------------|----------------------------|---------------------------|---|------------------|---|--|---|----------------------|
| Fire Door ফায়ার ডোর | Pure Water বিশুদ্ধ পানি | P.A System পিএ সিস্টেম | Smoke Detector সোয়া সনাক্তকারী যন্ত্র | CCTV সিসিটিভি | Exit বাহির | Fire Alarm Switch ফায়ার এলার্ম সুইচ | Danger বিপদজনক | |



AREA 1800 SQ FT

factory layout



Virgo M H Limited

EMERGENCY FIRE SAFETY & EVACUATION PLAN জরুরী অগ্নি নিরাপত্তা ও বহির্গমন পরিকল্পনা

UTILITY BUILDING(1ST FLOOR) ইউটিলিটি বিল্ডিং(২য় তলা)

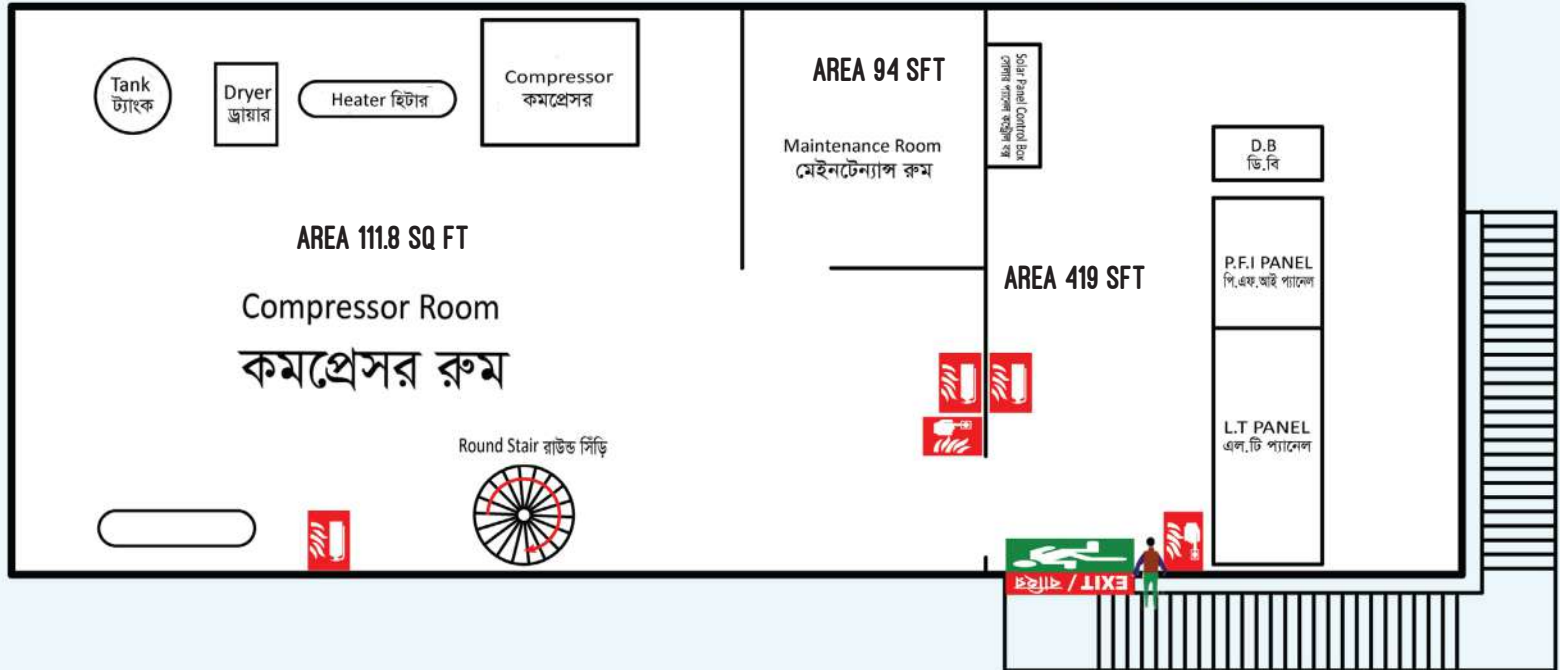

LEGEND

| | | | | | | |
|---------------------------|----------------------------|---------------------------|--|--|--|---|
| I am here আমার অবস্থান | Hose Pipe হোজ পাইপ | Pillar পিলার | Fire Equipment অগ্নি নির্বাপনী সরঞ্জাম | Fire Extinguisher অগ্নি নির্বাপক যন্ত্র | First Aid Box প্রথমিক চিকিৎসা বাক্স | Fog Light ফগ বাতি |
| Fire Door ফায়ার ডোর | Pure Water বিশুদ্ধ পানি | P.A System পিএ সিস্টেম | Smoke Detector ধোঁয়া সনাক্তকারী যন্ত্র | CCTV সিসিটিভি | Exit বাহির | Fire Alarm Switch ফায়ার এলার্ম সুইচ |
| | | | | | | Danger বিপদজনক |



AREA 1800 SQ FT

our products

- MEN'S FORMAL SUIT
- MEN'S FORMAL BLAZER
- MEN'S FORMAL TROUSER
- LADIES COAT
- LADIES BLAZER
- LADIES TROUSER
- LADIES SKIRT



our buyers



CELOPMAN

8 Production Lines

Blazer 36,000 / month

Trouser / Skirt 60,000/ month



o u r p r o d u c t s



our products



our products



s t o r e d e p a r t m e n t

Store department receives all new material for any new orders.

Main Functions of our store department are:

- = 4 Point Fabric inspection system
- = Accessories inspection AQL 1.5
- = Inventory maintain of all material received
- = Issue materials to the various department as per requirement.
- = Machinery & Equipment stock management
- = Office stationary management

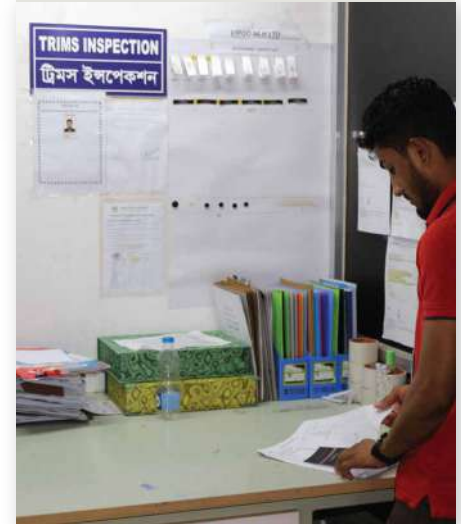

Fire Safety measures

Emergency FOG Light



Smoke Detector



Sprinkler System



Bonded Warehouse



Fire Hose Rack



Fire Alarm Control



Exit Fire Door



Exit Sign



Emergency Fire Button



Fire Service Connection



Pump Room

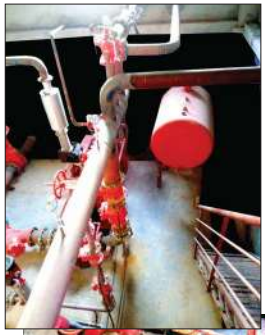

Fire Extinguisher



General Safety measures

First aid Team



Fire Response Team



Rescue Team



Danger Sign



First Aid Box



Metal Disposal Box

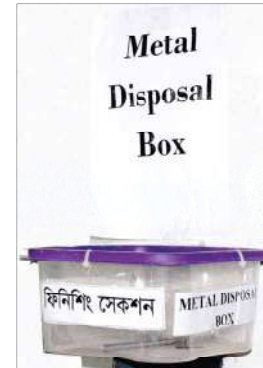

washroom notices



Notice for Sharp Objects



Needle Control Room



Needle Detector



Security measures

Biometric
Access Control



No ID No Entry



Security Officers
at check point



Security Officer
with Metal Detector



CT-PAT Area



Car Checking

Utilities

Generator



Sub station



Vacuum room



Diesel Boiler

Coal Boiler



Control panel



Compressor



worker welfare

Dinning Hall



Canteen Store



Emergency Fire Safety & Evacuation Plan :
Dinning Hall



worker welfare

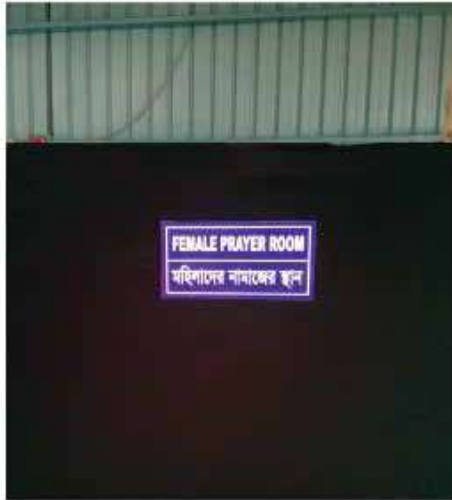

Prayer room



Doctor's room



Day Care Center



F a c i l i t i e s



Loading / Unloading Area



Spot Removing Room

Special Machines



Hand Stitch Machine



Eyelet Hole Machine



APW Machine



Sleeve Decoration Machine

special machines



Busting Machine



Heat Sealed Button Wrapping Machine



Shoulder Pad Attach Machine



Sleeve Join Machine



Button Attach Machine

special machines



— Cutting Machine



— Thread Sucker Machine



— Band Knife Machine



— Fusing Machine



special machines



Sleeve Press

Body Press



Collar Press



C A D S e c t i o n



Pattern Making



Pattern Cutting Machine



Plotter

Machine List

| SL/No | MACHINE NAME | BAND | MODEL NO |
|-------|---------------------|---------|-------------|
| 1 | P/M MACHINE | JUKI | DDL-900B-MS |
| 2 | P/M MACHINE | JUKI | DDL-900AS |
| 3 | P/M VARTICAL | JUKI | 5200N |
| 4 | ZIGZAG | JUKI | LZ 2280 A |
| 5 | ZIGZAG | JUKI | LZ 2284 AT |
| 6 | PLAIN BASTTING | JUKI | DDL-900AS |
| 7 | TWO NEEDLE | JUKI | LH 3568A-7 |
| 8 | SADDEL STITCH | BENLI | BL-T388 |
| 9 | CHAIN STITCH | JUKI | ML-111 |
| 10 | CHAIN STITCH/DOUBLE | JUKI | MH-380 |
| 11 | OVERLOCK/5TH | JUKI | 6716S |
| 12 | OVERLOCK/3TH | JUKI | 6704S |
| 13 | OVERLOCK/3TH | JUKI | 6704DA |
| 14 | OVERLOCK/CHAIN 2 TH | PAGASUS | M922-02 |
| 15 | BUTTON STITCH | JUKI | 1903B-SS |
| 16 | BARTACK | JUKI | 1900B-SS |
| 17 | EYELET HOLE | DURKOPP | 580-121 |
| 18 | SLEEVE SETTING | DURKOPP | 650-10 |
| 19 | A.P.W M/C | DURKOPP | 745-35-01 |
| 20 | BAND KNIFE | KAIGU | DCQ1200-II |

| SL/No | MACHINE NAME | BAND | MODEL NO |
|-------|----------------------------|---------------|----------------|
| 21 | FABRIC/INSPE | WEISHI | YB1-1808 |
| 22 | NUMBERING M/C | Blitz | 2253 |
| 23 | NEEDLE/ DETECO | HANMA | HAM-160 |
| 24 | CUTTING M/C | CHINA FJ8" | FJM103 |
| 25 | HOOK & BAR BUTTON M/C | K.O | III |
| 26 | BUTTON ATTACH AND WRAPPING | JUKI | 289 |
| 27 | PLOTTER /CUTTER | SINAJET TECH | FG1209 |
| 28 | DIGITIZER | CHAINA | 3648 |
| 29 | PLOTTER /MARKER | CHINAWAY | JET1600C-Z |
| 30 | FUSSING M/C | WEISHI | HJH-1000A/9000 |
| 31 | BLIND STITCH | | VEB-100-2 |
| 32 | BLIND STITCH | STROBAL | VEB-100-1 |
| 33 | BELT LOOP MAKING | KANSAI | B-2000C |
| 34 | LIGHT BOX | CHINA | KAI-70 |
| 35 | AUTO LEA CUTTER | HANGHAI ZUOSE | CZD-B-11 |
| 36 | WEST BELT TACK | STROBAL | K.560-21-C |
| 37 | SHULDER P/JOIN | STROBAL | 697-15155 |
| 38 | SHULDER P/JOIN | STROBAL | 697-24155 |
| 39 | HAND STITCH | SHDA | SK-786A |
| 40 | SLEEVE DECORATION | REECES | S-4000 |

| SL/No | MACHINE NAME | BAND | MODEL NO |
|-------|--------------------------|--------------|--------------|
| 41 | PLASTICK STAPLER | CHINA | CHINA |
| 42 | REVERSIBLE CLOTH DIVIDER | JAYA | JAYA |
| 43 | BUTTON WRAPPING | ASSCOLITE | MK-13 |
| 44 | BUTTON HOLE | JUKI | LBH-1790 AS |
| 45 | PRESS MACHINE | WEISSHI | AZT-018 |
| 46 | PRESS MACHINE | WEISSHI | AZT-C36 |
| 47 | PRESS MACHINE | WEISSHI | AZT-C26A |
| 48 | PRESS MACHINE | WEISSHI | AZT-011 |
| 49 | PRESS MACHINE | WEISSHI | G-358 |
| 50 | PRESS MACHINE | WEISSHI | G-55 |
| 51 | PRESS MACHINE | WEISSHI | A-65 |
| 52 | PRESS MACHINE | WEISSHI | A-26 |
| 53 | IRON / TABLE | WEISHI | W-26 |
| 54 | IRON / TABLE | WEISHI | YT-Q-R |
| 55 | IRON / TABLE | WEISHI | MZT-033 |
| 56 | LEG IRON TABLE | WEISHI | YTQ-V-13 |
| 57 | SIDE CUTTER | SHDA | SK-103N-3 |
| 58 | HIGH BASTTING | SHDA | SK-333 |
| 59 | SPOT REMOVING MACHINE | MAX | 460 |
| 60 | BOILER | YUANDA CHINA | DZL2-1.0-AII |

| SL/No | MACHINE NAME | BAND | MODEL NO |
|-------|-----------------------------------|-------------|-------------|
| 61 | BOILER | CHINA | WNS6-1 |
| 62 | COPPRESSER | BOGE | DRC120 |
| 63 | BACCUAM | CHINA | CHINA |
| 64 | GENERATOR-1 | PERKINS | 17E12695/1 |
| 65 | GENERATOR-2 | PERKINS | 17E12695/2 |
| 66 | TRANSFORMAR (1500 KVA) | BETELCO | |
| 67 | ELECTRIC MOTOR FIRE PUMP (150 HP) | NAFFCO | NF-S150-100 |
| 68 | JOCKEY PUMP (5 HP) (Electric) | NAFFCO | NFVL4-190 |
| 69 | DIESEL ENGINE FIRE PUMP (185 HP) | NAFFCO | NF-S150-100 |
| 70 | STEAM IRON | WEISHI | A-22 |
| 71 | STEAM IRON | WEISHI | A-32 |
| 72 | LEVEL CUTTER | GOLDEN EGOL | |
| 73 | MOISTURE METER | AQUA | AQUA |
| 74 | WEIGHT MACHINE | MEGA | MEGA |
| 75 | Poly Seal Machin | KingSter | |

NOTES

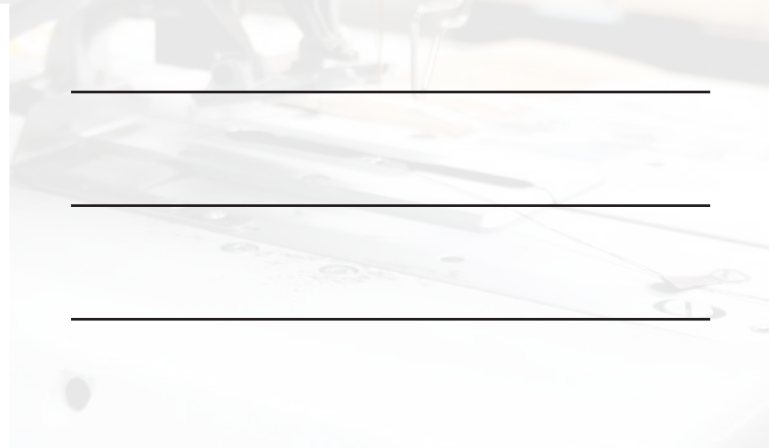

NOTES



NOTES



NOTES





VIRGO M H LIMITED

(Virgo Mahabuba Holdings Limited)

Head Office:

House #178, Road # 2, Baridhara D.O.H.S,
Dhaka - 1206, Bangladesh
Phone : +880 2 8410674
Email: vmh@virgo.com.bd

Factory Address:

43/2, Gazipura, BOF, Gazipur Sadar,
Gazipur, Bangladesh

web : www.virgomh.com